

THE SHOPPES AT VERDANA VILLAGE

FOR LEASE • PUBLIX-ANCHORED NEIGHBORHOOD CENTER
VERDANA VILLAGE BLVD • ESTERO, FL 33928



PROPERTY FEATURES

PRICING:

CALL FOR DETAILS

AVAILABLE:

OP 1 - 1.42± AC

OP 2 - 1.23± AC

OP 3 - 0.99± AC

BLDG. A - 1,200 - 7,500± SF

BLDG. B - 1,200 - 4,800± SF

LOCATION:

The subject site is located on the SEC of Verdana Village Blvd & Corkscrew Rd in Estero, FL. Corkscrew Rd is the main east/west arterial roadway that extends from US 41.



VERDANA VILLAGE

IS A PUBLIX-ANCHORED NEIGHBORHOOD CENTER LOCATED IN THE THE MAIN ENTRANCE TO VERDANA VILLAGE, AN APPROVED PROJECT THAT WILL BE DEVELOPED WITH 2,400 HOMES.

CONTACT US:

TONY MANGIONE

Principal
239.334.3040
tony.mangione@trinitycre.com

TY HENSLEY

Advisor
239.334.3040
ty.hensley@trinitycre.com



THE SHOPPES AT VERDANA VILLAGE

FOR LEASE · PUBLIX-ANCHORED NEIGHBORHOOD CENTER
VERDANA VILLAGE BLVD · ESTERO, FL 33928

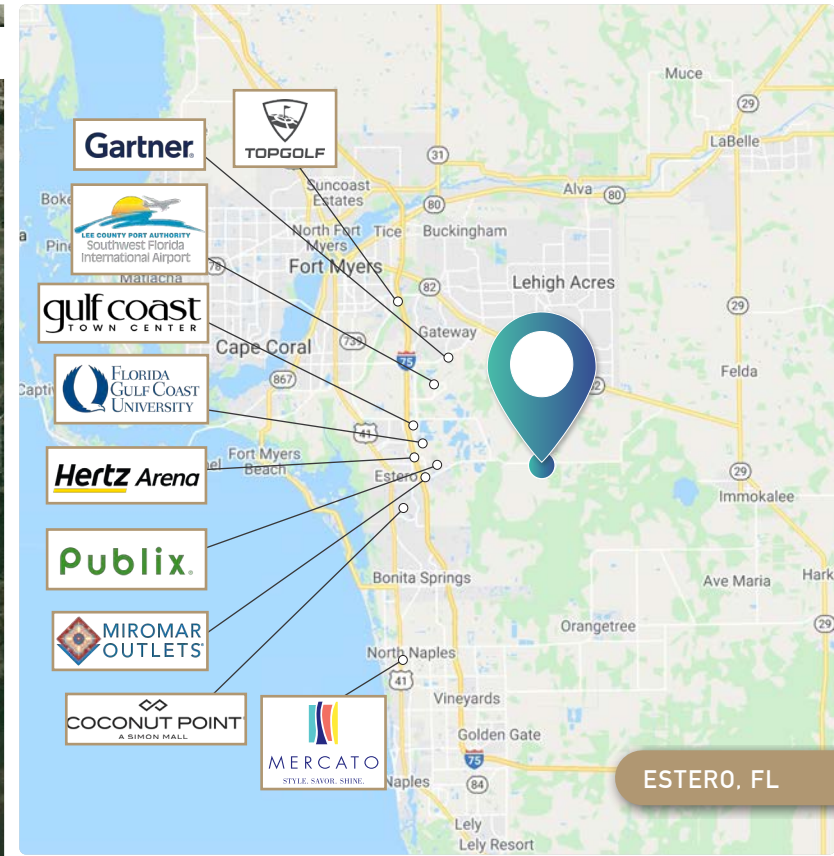

| | 2021 DEMOS | 3 MI RADIUS | 5 MI RADIUS | 10 MI RADIUS |
|--------------------------|------------|-------------|-------------|--------------|
| EST. POPULATION: | | 1,948 | 4,089 | 82,249 |
| EST. EMPLOYMENT DENSITY: | | 63 | 485 | 17,726 |
| AVG. H.H. INCOME: | | \$37,433 | \$40,725 | \$90,002 |



CONTACT US:

TONY MANGIONE
Principal
239.334.3040
tony.mangione@trinitycre.com

TY HENSLEY
Advisor
239.334.3040
ty.hensley@trinitycre.com



THE SHOPPES AT VERDANA VILLAGE

FOR LEASE • PUBLIX-ANCHORED NEIGHBORHOOD CENTER
VERDANA VILLAGE BLVD • ESTERO, FL 33928

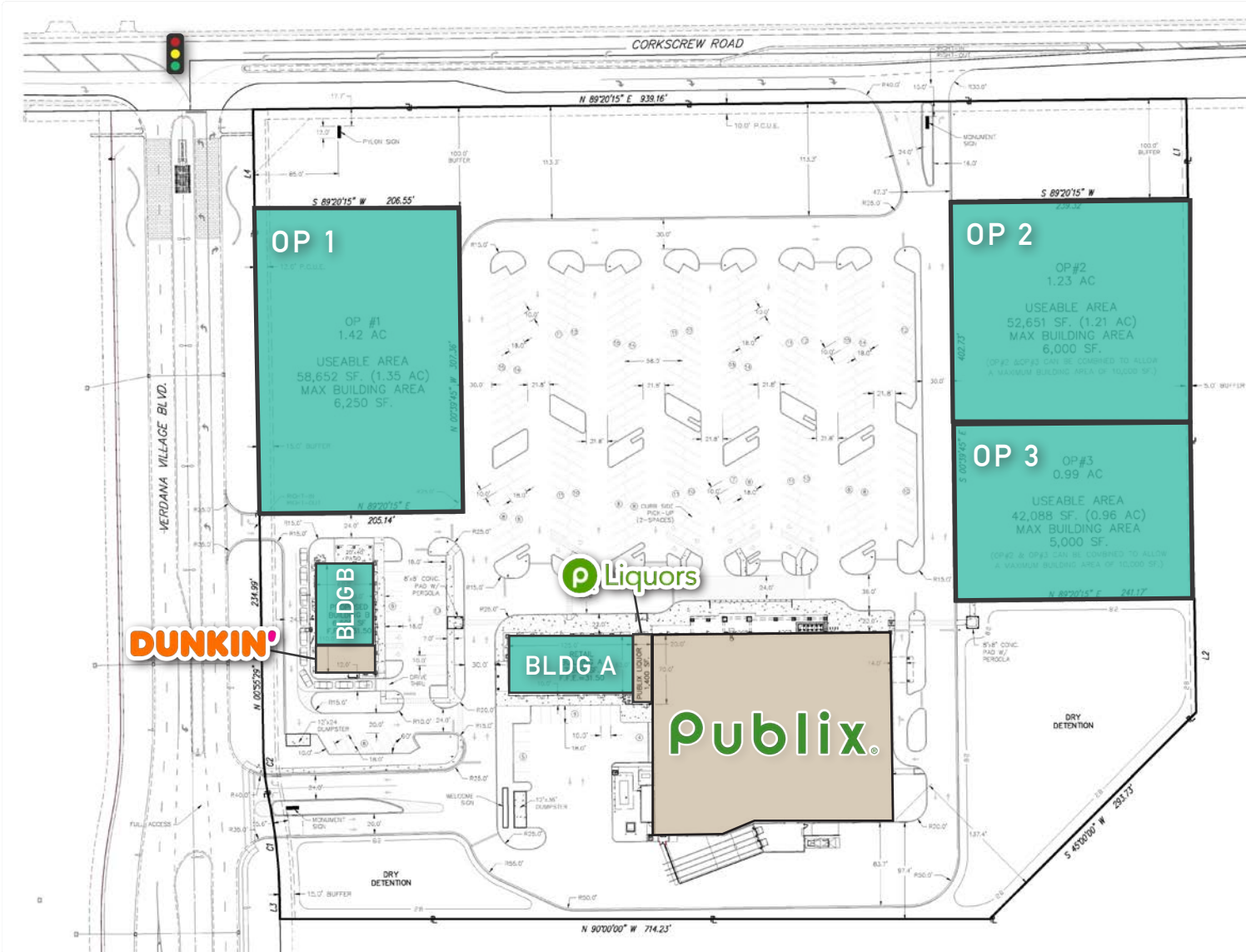

| # | TENANT | SIZE |
|---------|----------------|------------------|
| OP 1 | AVAILABLE | 1.42 AC |
| OP 2 | AVAILABLE | 1.23 AC |
| OP 3 | AVAILABLE | 0.99 AC |
| BLDG. A | AVAILABLE | 1,200- 7,500 SF |
| BLDG. B | AVAILABLE | 1,200 - 4,800 SF |
| BLDG. A | PUBLIX | 48,387 SF |
| BLDG. A | PUBLIX LIQUORS | 1,400 SF |
| BLDG. B | DUNKIN' DONUTS | 1,800 SF |

CONTACT US:

TONY MANGIONE
Principal
239.334.3040
tony.mangione@trinitycre.com

TY HENSLEY
Advisor
239.334.3040
ty.hensley@trinitycre.com



THE SHOPPES AT VERDANA VILLAGE

FOR LEASE • PUBLIX-ANCHORED NEIGHBORHOOD CENTER
VERDANA VILLAGE BLVD • ESTERO, FL 33928



COMMERCIAL DEVELOPER



WMGDEVELOPMENT

WMG Development LLC is a full-service national real estate investment and development company made up of an entrepreneurial team of creative problem solvers with “can-do” attitudes.

Throughout the years, WMG has executed a solid track record of successful development solutions. WMG develops commercial real estate projects for a variety of industry segments, including retail, healthcare and restaurants. WMG Development is currently in 33 states and has more than 58 active projects. The company’s expertise in site selection, as well as its quick-action responsiveness, makes WMG Development the premier retail developer in the United States.



Shoppes on Immokalee Road - Naples, FL



Shoppes at Palmer Ranch - Sarasota, FL

LEARN MORE ABOUT WMG DEVELOPMENT



Village Grove Dental Care - Buckeye, AZ



at&t and Liberty Dental Care - Kansas City, MO



Copperhead Dental Care - Parker, CO

trinitycre.com

9250 Corkscrew Rd • Suite 13 • Estero, FL 33928

© 2021 Trinity Commercial Group

This information is considered accurate, but not guaranteed.

